



EMS PHYSIO LTD



Traction Table instruction manual

Model Numbers: COU005, COU006

Contents

1. Introduction	3
General Warnings	3
2. Installation	4
Adjustable Foot	4
Power Supply	5
Lifting and Moving	5
3. General Operation	6
Electric Operation	6
Manual Head & Foot Sections	7
Retractable Castor Operation	7
4. Traction Operation (must be ordered separately)	8
Traction Package Contents	8
Traction Machine	9
Lumbar Traction	10
Cervical Traction (sitting)	11
Cervical Traction (lying)	12
5. Accessory Operation	13
Paper Roll Holder	13
Flexion Stool	13
Cervical Pillow	13
6. Cleaning and Decontamination	14
7. Troubleshooting	15
8. Maintenance	16
9. Technical Specification	17
10. Certificate of Conformity	18
11. Revisions and Notes	19

EMS PHYSIO LTD is certified to ISO 13485



Our products are CE marked in conformity with the EC Directive MDD 93/42/EEC

1. Introduction

Thank you for purchasing a product from EMS PHYSIO LTD. We use the highest quality components and manufacturing techniques to ensure that our products are simple to use and will last a long time. It is recommended that all users read and retain this User Manual for reference.

Throughout this manual notice is made of a Warning and Caution system to highlight to the user practices, procedures or conditions that should either not be allowed to happen or happen with caution.

Warnings are in a box with bold type and identify potential hazards, procedures or conditions which could result in death, injury or serious damage.

Cautions are in a box with plain type and identify conditions or procedures where if caution is not taken it may result in damage or failure of equipment.

General Warnings

WARNING

Maximum Load (SWL) is 250kg distributed evenly.

Do not use flammable gasses in proximity to an electrically operated couch.

Do not concentrate weight on either side or either end of the couch.

Use only accessories approved for use with this couch.

Disconnect power supply before moving couch.

Children must be adequately supervised in the presence of the couch.

Do not allow children to play with the couch at anytime.

2. Installation

Although this couch comes complete and is virtually ready to use it is important to remove all packaging and read the following before use.

Retractable Castors

The castors can be operated from either side of either end of the couch. Press the pedal down to engage the castors and lift the pedal to retract the castors.

Please refer to the Operation section on page 7 for further details.

WARNING

Castors must be retracted before the couch is used and whilst patients get on or off the couch.

Care should be taken to ensure patients do not trip over any part of the couch when getting off.

Adjustable Foot

Fitted to the head end of the couch is an adjustable foot. This is designed to stabilise the couch and must be set before use. The foot should be wound in/out until it is firmly in contact with the floor whilst the castors are retracted. Check that the couch is firm and stable and then adjust the lock nut back up against the couch leg to lock the adjustable foot in position. Incorrect adjustment will result in the couch being unstable and the wheel pedals difficult to operate.

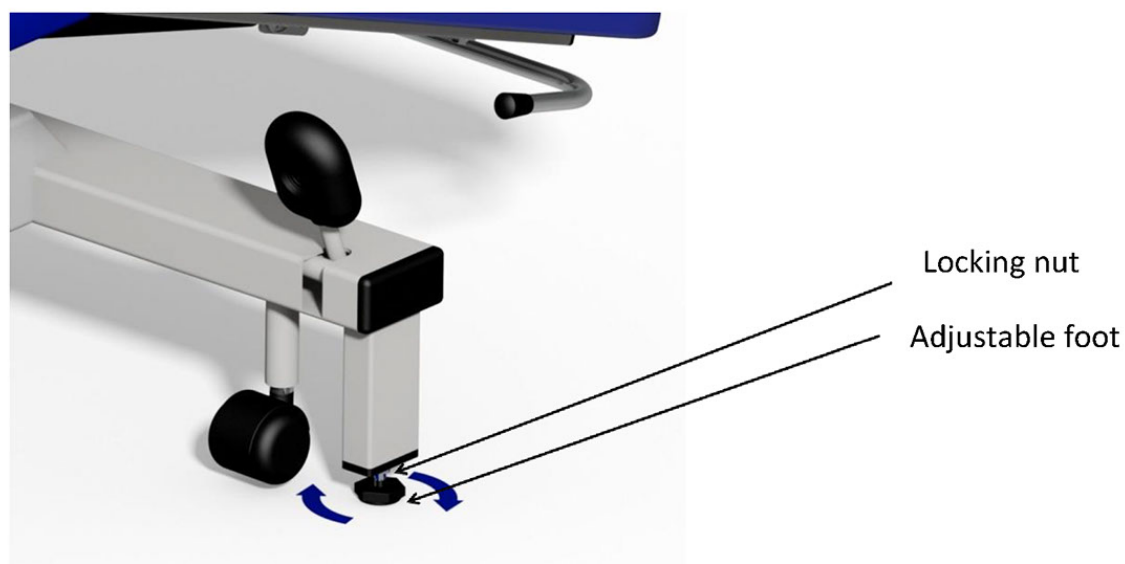

Power Supply (electric version only)

Ensure that hand or foot switch leads are clear of the moving parts of the couch before operation. Connect the couch to a normal domestic type power supply observing the following notes.

WARNING

Ensure that the mains lead, plug and socket are in good condition before connecting the equipment.

Ensure that the mains cable has a clear run and is not stretched when connected and that no one can fall over the cable.

CAUTION

When couch is not in use switch off power supply.

Lifting and Moving

Should the couch need to be moved or lifted (for example to remove it from its packaging) then a minimum of two people are required. The couch must only be lifted by the metal base frame near the wheels. If the couch is upside down then it may be carried by holding it underneath the upholstery. When turning the couch over, please make sure the frame and upholstery are supported at all times, otherwise damage may occur to the upholstery and gas springs.

CAUTION

Under no circumstances lift the couch by the upholstery or top sections as damage will occur to the gas spring mechanisms.

3. Operation

EMS PHYSIO LTD offers 2 models of traction table, COU005 being the hydraulic version and COU006 being the electric version

Electrical Operation General

WARNING

Safely position patient before operating any functions.

Position the switch in a place where it is clear of the moving parts of the couch and where accidental operation is not possible.

Ensure that all electrical cables are clear of the moving parts of the couch.

Electrical Operation (hand single motor)

For model COU006 electric couches the standard hand switch fitment is a pneumatically operated rocker switch as shown below.

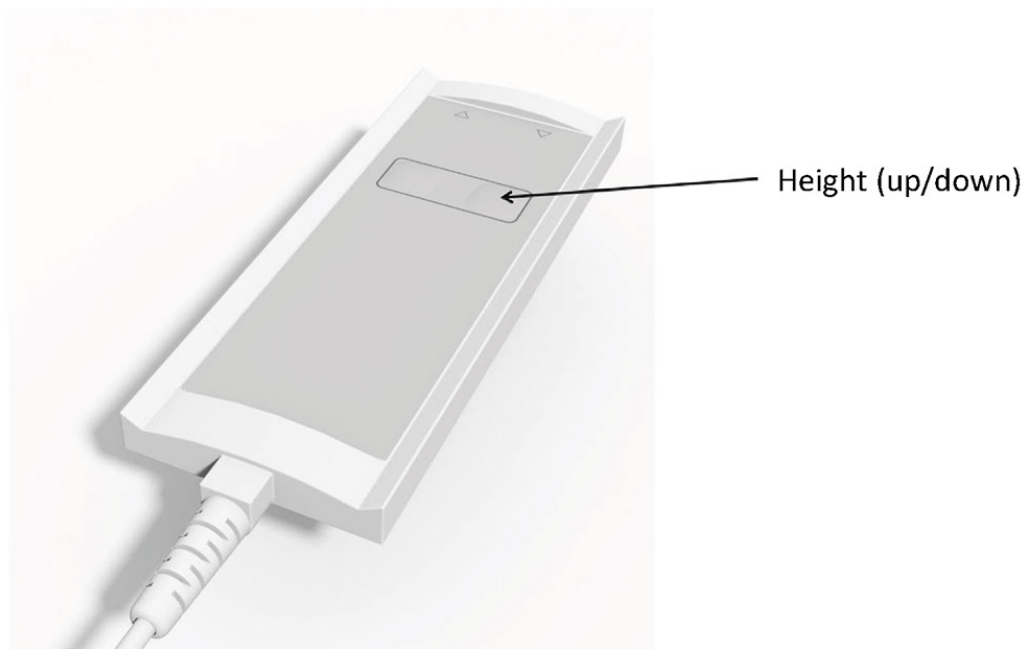

Electrical Operation (foot)

As an option this couch may be supplied with a foot switch to operate the electrical functions. It will operate in the same way as the hand switch but must be placed on the floor and operated by foot. For further information see page 10.

Manual Head & Foot Sections

For versions that do not have a motorised head section. The operation is via a gas spring mechanism triggered with a lever as shown below:

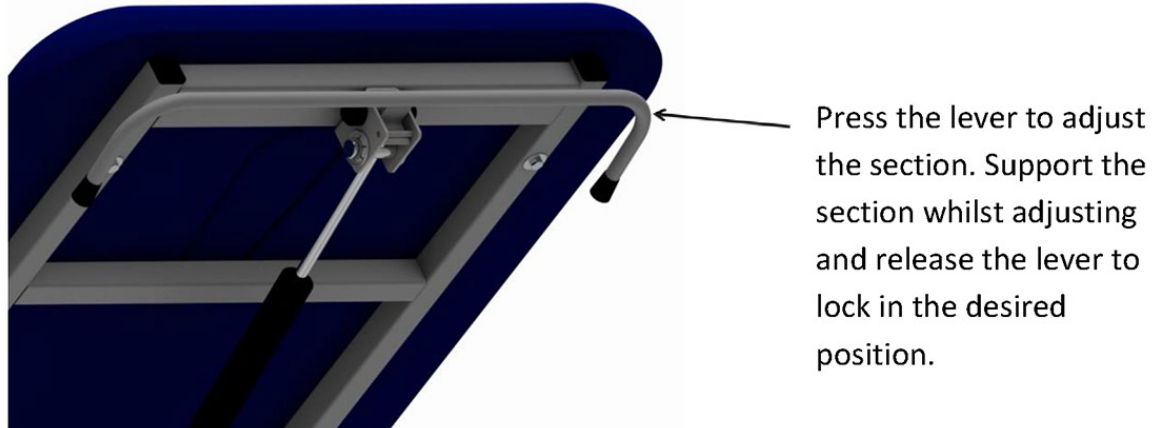

Retractable Castor Operation

The castors fitted to this couch are 50mm retractable castors. They are operated individually at each corner of the couch via the wheel pedals.

NOTE – the castors are not designed for patient transport.

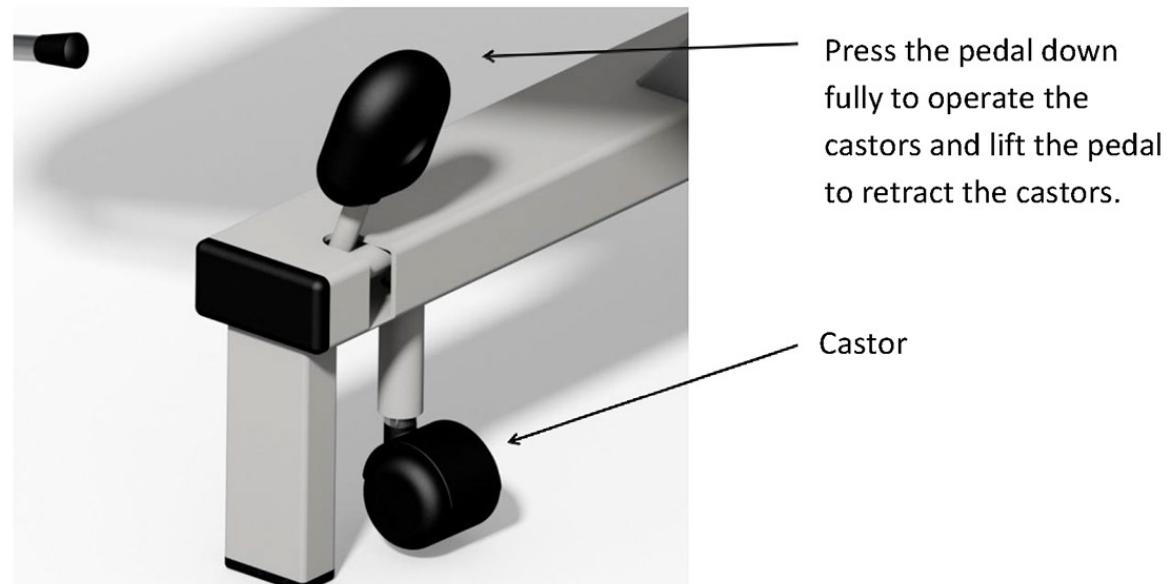

WARNING

Castors must be locked before the couch is used and whilst patients get on or off.
Disconnect and coil electrical leads and switch away from the couch mechanism prior to moving the couch.

4. Traction Operation

This section provides key information in setting up the traction table for Lumbar and Cervical traction. Please check that you have all of the following items (bear in mind that if you did not buy a Traction machine direct from EMS PHYSIO, then some of the items marked with a star (*) may not be present. Please also note that we supply the Traction Machine Table to fit the EMS PHYSIO Traction machine and other machines may not fit, or may fit with modification. Please contact us if you require assistance.

Traction Package Contents:

1. Traction Couch
2. Traction Machine Table
3. Lumbar Traction Mast
4. Set of three masts for cervical in sitting
5. Spreader Bar
6. Head Halter
7. Pelvic Belt
8. Thoracic Harness
9. Counter Traction Straps
10. Traction Machine - optional purchase
11. Flexion Stool*

Traction Machine

The standard fitment with the EMS PHYSIO Traction table is the RH087 Traction Machine which is one of the world's leading units. It is supplied with full user instructions in the packaging and is fixed to the machine table as follows:

Rope head may be turned through 360 degrees allowing a choice of 4 mounting positions

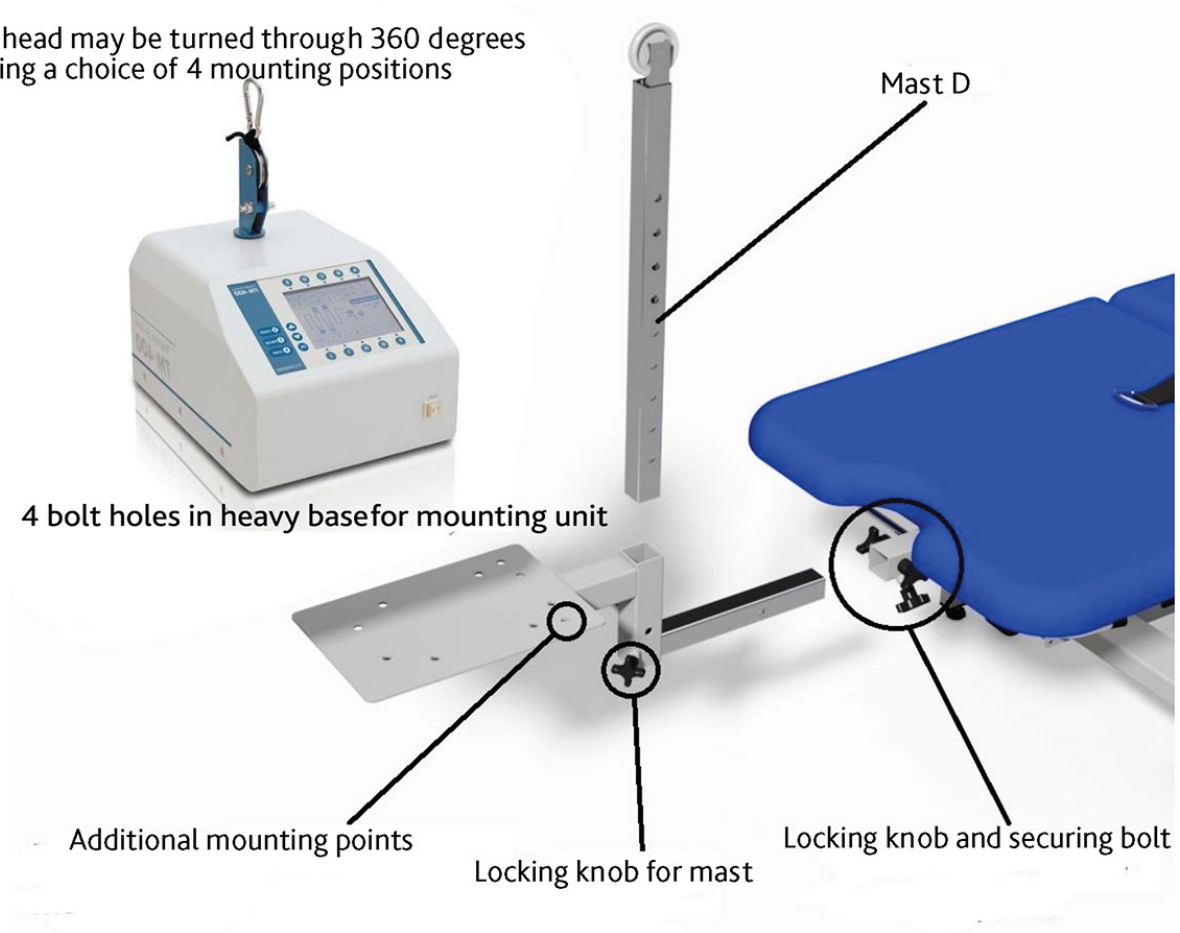

Fit machine table to couch - first loosen the locking knob and remove fitting bolt on the traction couch before sliding the machine table in and re-fitting fitting bolt and tightening the knob

Fit traction machine to machine table - insert the hook on the bottom of the traction machine over the machine table and tighten using the lock knob on top of the unit. Then fix the other end in place using the thumb wheel provided with the traction machine. Check the traction machine is secure.

Fitting mast - slide Mast D into the machine table, adjust with the plunger mechanism and secure with the locking knob.

WARNING

Ensure that the Traction Machine is properly fixed before use.

Lumbar Traction

The picture below shows the traction couch set up for lumbar traction. Only one mast is required for this procedure (Mast D), this has a pulley on the top and several adjustment holes for different angles of flexion. The mast is fitted into the Machine Table and adjusted with the small index plunger in the Machine Table.

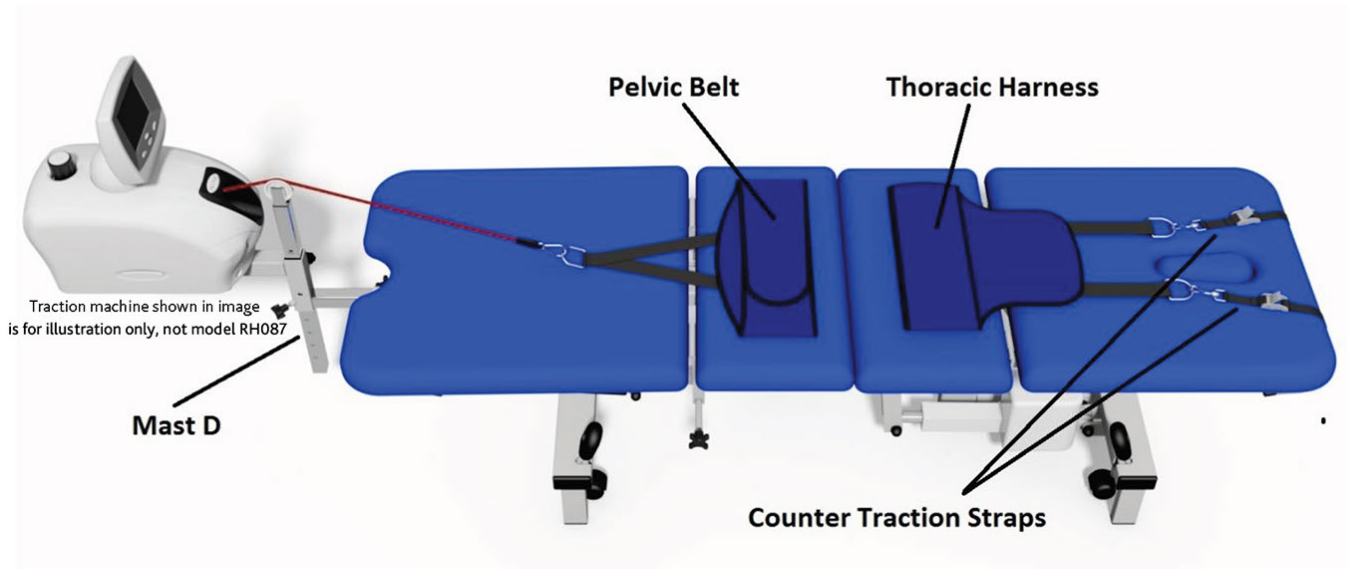

The Pelvic Belt is attached directly to the rope from the traction machine and the Thoracic Harness is attached to the back frame of the couch using the adjustable Counter Traction Straps provided.



The clips on the end of the straps should be securely fixed on to the bracket on the back frame of the couch.

NOTE:

Correct fitting of the harnesses to the patient is crucial to achieve the best results. The harnesses should fit as snugly as possible to minimise any potential slipping during treatment.

Cervical Traction (sitting)

The picture shows the traction couch set up for cervical in sitting traction.

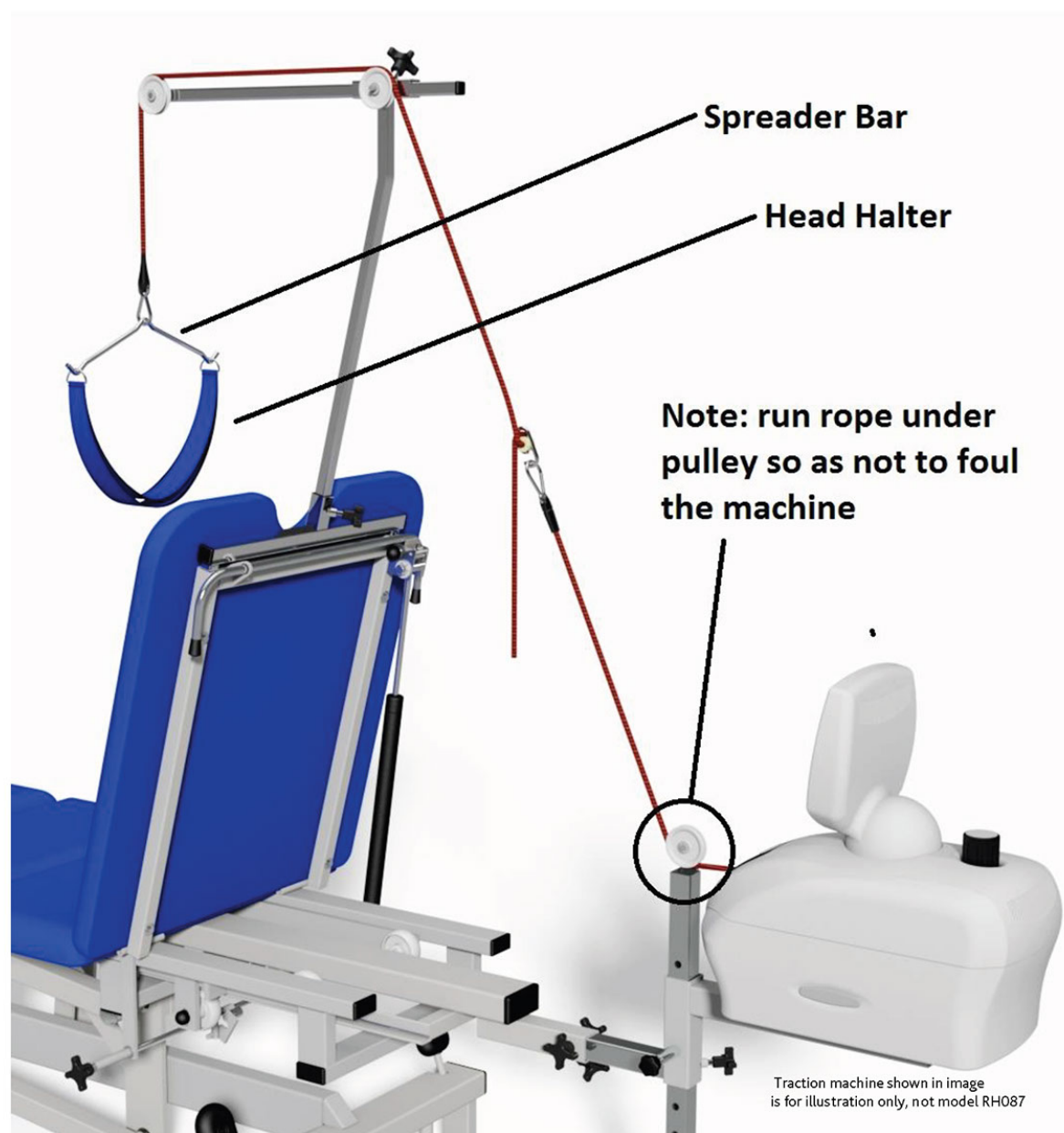

WARNING

Ensure that the Traction Machine is properly set for cervical traction before use see Traction User Manual for details.

Fitting Masts – all three cervical masts (Masts A, B & C) are fitted as follows:

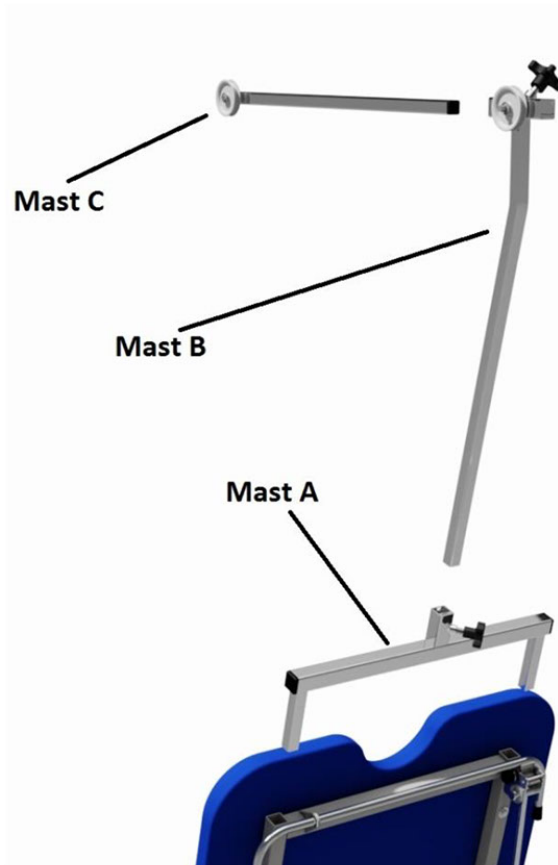

Mast A fits into the backrest of the couch. Elevate the backrest, check that there are no caps fitted which would prevent the mast fitting and slide the mast in. Ensure that the locking knob is facing you otherwise it will foul with the upholstery.

Mast B fits into the socket of Mast A. The curve in the mast should face towards the patient and the pulley will be on the left hand side (looking from the machine towards the patient).

Mast C plugs into the socket on Mast B. Ensure that both pulleys line up (again the pulley should be on the left side as above). This mast is adjustable for different angles of flexion.

Connecting Machine - The machine may now be connected using the spreader Bar and Extension Rope (included with the traction machine).



The extension rope is attached to the end of the traction machine as shown and should be adjusted to run smoothly over the pulleys before attaching to the spreader bar.

Cervical Traction (Lying)

In addition to cervical in sitting, cervical in a lying position may also be used on this equipment. There is no need to use the three masts as above, nor the extension rope; instead the spreader bar fits straight onto the traction machine rope system.

5. Accessory Operation

A range of accessories are available as options to expand the use of the couch. The standard recommended accessories are detailed below. Many of these can be fitted retrospectively if required.

Paper Roll Holder



Paper roll is replaced by removal of one or the other of the plastic knobs, sliding the bar partially through the leg of the holder and then fitting the tube over the bar. Refit in the reverse order.

Flexion Stool



A flexion stool may also be purchased separately. It is simply adjusted for height using the locking knob shown

Cervical Pillow

A cervical pillow providing additional support and comfort for the patient is available.

6. Cleaning and Decontamination

WARNING

If contamination is suspected then decontaminate the couch before use.

Torn or damaged upholstery should be replaced immediately.

Cleaning your couch

Keeping your couch clean will assist in prolonging its working life.

With hydraulically operated models regular cleaning of the stainless steel ram (eg by using a soft cloth) prevents dust from wearing the seal. For all other parts wipe down using a damp cloth and warm soapy water.

The use of solvents, abrasives, synthetic detergents, wax polishes, leather cleaner or aerosol spray is not recommended. It is recommended that if oils are likely to be used that the upholstery is covered with either paper towelling or a couch cover.

Wipe clean regularly with a microfiber cloth and warm soapy water to remove dust particles and light soiling. If spillages occur, remove promptly with an absorbent dry cloth.

Where disinfection is necessary bleach based disinfectants such as Chlor-Clean, Haz-Tab, Milton and Tristel are safe to use with a damp cloth, following the manufacturers' instructions.

When using bleach, a 5% solution is acceptable (50,000ppm)

Follow the above with a clean water rinse and dry with a soft cloth or towel. For heavy or ingrained soiling follow the cleaning steps as detailed above, then scrub the affected area using a soft brush and warm soapy water, followed by a clean water rinse and dry.

Using cleaning products contrary to these instructions may compromise the integrity of the fabric.

Unsuitable cleaning products will remove the lacquer layer which protects the vinyl fabric and result in hardening and/or cracking of the fabric

Always cover the vinyl with paper towelling or couch covers if it can come into contact with bare skin.

7. Troubleshooting

In the unlikely event of the couch failing to operate and having carried out the normal practical fault finding steps below then please contact our Customer Service Team on +44 (0) 1235 772272 or email sales@emsphysio.co.uk

Please tell us the serial number of the couch when you contact our team so that we can help you more efficiently.

Fault	Possible Cause	Remedy
Couch is unstable	Uneven floor	Move couch to flat floor
	Adjustable foot	Check presence, condition and adjustment of foot
All motors will not work (COU006 only fitted with optional motor back)	Power disconnected	Connect power supply
	Fuse Blown	Replace fuse in plug
	Hand/ Footswitch disconnected	Check the switch is fully connected to the motor
One motor will not work but others working (COU006 only fitted with optional motor back)	Lead from height motor/control box not connected to slave motor	Check and connect all leads
	Fault with switch	Replace switch
	Fault with control box	Replace control box
	Fault with motor	Replace motor
Motor sinks (COU006 only)	Switch permanently operated	Unplug and re-connect switch
	Motor fault	Replace motor
Hydraulic pump will not work (COU005 only)	Pump fault	Replace pump
Hydraulic pump sinks (COU005 only)	Valve stuck	With couch at max height pump pedal for a further 20-25 strokes to clear valve
Backrest will not work (manual versions)	Gas spring incorrectly adjusted (not being triggered)	Rotate gas spring until the pin is just in contact with the lever (2-3mm play required)
	Gas spring faulty	Replace gas spring
Backrest sinks under load (manual versions)	Gas spring incorrectly adjusted (permanently triggered)	Rotate gas spring until the pin is just in contact with the lever (2-3mm play required)

8. Maintenance

EMS Physio Ltd products are designed to be maintenance free. However keeping your EMS products clean and regularly checked will assist in prolonging their working life. The following is a guide of simple checks that the user can carry out on a six monthly basis. We would also recommend an annual service visit by an EMS PHYSIO LTD trained engineer.

WARNING

Disconnect couch from electrical supply before commencing any of the following checks.

Examine the couch for any signs of damage. Pay particular attention to all nuts, bolts and fasteners to check they are present and tight but not over tight.

Upholstery bolts should all be checked (each section has between 2 and 6 No. M6 bolts), they should all be present and tight.

Check gas struts (if fitted) and ensure that they operate through the full range of movement and lock fully.

Check hinge pins are lubricated.

Check main couch nylon pivot bearings are lubricated sufficiently.

Examine mains and switch cables for any damage, cuts, kinks, abrasions etc. These must be replaced if necessary.

Check mains lead, switch cables and slave motor leads are all correctly and securely attached.

Check correct plug fuse is fitted (5A).

WARNING

Any electrical checks or work other than the visual inspection above must be performed by a qualified electrician.

Do not connect BLUE or BROWN wires to the earth terminal of a plug.

10. Technical Specifications

	COU005	COU006 (1 motor)	COU006 (2 Motor)	
Head Length (cm)	63	63	63	
Seat Length1 (cm)	31	31	31	
Seat Length2 (cm)	31	31	31	
Foot Length (cm)	71	71	71	
Width (cm)	63	63	63	
Overall Length (cm)	198	198	198	
Height Range (cm)	47-97	47-97	47-97	
Max Working Load	250kg	250kg	250kg	
Control	Pedal	Hand switch	Hand switch	
Hydraulic Pump	Roemheld	N/A	N/A	
Electrical Data 220/240v				
Motor(s)	N/A	Linak LA31 x 1	Linak LA31 x 2	
Control Box	N/A	Linak CB09	Linak CB09	
Current	N/A	1.5A	1.5A	
Power	N/A	360W	360W	
Mains Plug Fuse	N/A	5.0A x 1	5.0A x 1	
Internal Fuse	N/A	1.5A x 1	1.5A x 1	
System Voltage	N/A	24v	24v	
IP Rating	N/A	IPX4	IPX4	
Electrical Data 110/120v				
Motor(s)	N/A	Linak LA31 x 1	Linak LA31 x 2	
Control Box	N/A	Linak CB09	Linak CB09	
Current	N/A	2.7A	2.7A	
Power	N/A	360W	360W	
Mains Plug Fuse	N/A	5.0A x 1	5.0A x 1	
Internal Fuse	N/A	3.0A x 1	3.0A x 1	
System Voltage	N/A	24v	24v	
IP Rating	N/A	IPX4	IPX4	

IEC 601-1 Electrical Safety Classification

All electric models are double insulated Type B equipment and marked as such.

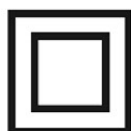

Double Insulated



Type B Equipment

Revisions:

Page 14 - updated cleaning instructions for improved vinyl care

Notes:





EMS PHYSIO LTD
GROVE TECHNOLOGY PARK
DOWNSVIEW ROAD
WANTAGE
OXFORDSHIRE
OX12 9FE

+44 (0)1235 772272
E: sales@emsphysio.co.uk
W: emsphysio.co.uk



Advena Ltd. Tower Business Centre, 2nd Flr.,
Tower Street, Swatar, BKR 4013 Malta